

Documents corresponding to the product:

Standard EN 60269-2; IEC269-2



Switch disconnectors

3 YEAR WARRANTY

The series of switch disconnectors are developed for short-circuit protection. They have a high speed of start and high reliability. They have a plastic body of non-flammable plastics adapted for mounting on a DIN rail, where a porcelain round plug, which is filled with fine quartz sand for extinguishing the electric arc. LED indicator is mounted on the front panel to show fuse link condition. In this ceramic body is mounted melting, specifically profiled plate, which connects the input power terminals. These terminals are produced from copper alloy with especially laid nickel layer and contact with the projecting bolts from the plastic body. There are offered two types of

insertions according to the degree of quick operation: normally quickly operating ones – class “gG”. Suitable for DC system.

Technical data:

- Rated voltage: 500V
- Insulation voltage: >2500V
- Rated current on short-circuit: 100 kA
- Direct mounting to the load
- Two insulated points to the load
- IP code: IP 44
- Cross-section of the supply conductors: up to 35mm²
- Environmental temperature: -5° to +65°C
- Utilization category: AC - 20B; DC - 20B
- Altitude: up to 2000m

Overall dimensions

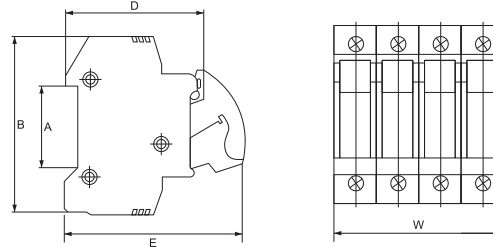

Base type	Number of poles	Rated current (A)	Type of the fuse	Base dimensions (mm)					Packing / Box (pcs)	Catalogue number
				A	B	W	D	E		
1PRT18 - 32x	1P	32	xxG1038	37	82	18	60	78	12 / 240	10RT1831
1NRT18 - 32x	1P+N	32	xxG1038	37	82	36	60	78	12 / 240	10RT18311
2PRT18 - 32x	2P	32	xxG1038	37	82	36	60	78	12 / 240	10RT1832
3PRT18 - 32x	3P	32	xxG1038	37	82	54	60	78	12 / 240	10RT1833
3NRT18 - 32x	3P+N	32	xxG1038	37	82	72	60	78	12 / 240	10RT18331
1PRT18 - 63x	1P	63	xxG1451	37	105	27	80	110	6 / 108	10RT1861
1NRT18 - 63x	1P+N	63	xxG1451	37	105	54	80	110	6 / 108	10RT18611
2PRT18 - 63x	2P	63	xxG1451	37	105	54	80	110	6 / 108	10RT1862
3PRT18 - 63x	3P	63	xxG1451	37	105	81	80	110	6 / 108	10RT1863
3NRT18 - 63x	3P+N	63	xxG1451	37	105	108	80	110	6 / 108	10RT18631

Type of the fuse class gG	Voltage (V)	Rated current (A)	Size of the fuse A x ØB x C	Packing / Box (pcs)	Catalogue number
01G1038	500	1	38xØ10.3x10mm	10 / 2000	10G10381
02G1038	500	2	38xØ10.3x10mm	10 / 2000	10G10382
04G1038	500	4	38xØ10.3x10mm	10 / 2000	10G10384
06G1038	500	6	38xØ10.3x10mm	10 / 2000	10G10386
10G1038	500	10	38xØ10.3x10mm	10 / 2000	10G103810
16G1038	500	16	38xØ10.3x10mm	10 / 2000	10G103816
20G1038	500	20	38xØ10.3x10mm	10 / 2000	10G103820
25G1038	500	25	38xØ10.3x10mm	10 / 2000	10G103825
32G1038	500	32	38xØ10.3x10mm	10 / 2000	10G103832
40G1451	500	40	51xØ14.3x12mm	10 / 1000	10G145140
50G1451	500	50	51xØ14.3x12mm	10 / 1000	10G145150
63G1451	500	63	51xØ14.3x12mm	10 / 1000	10G145163